

AREA SCHEDULE							
DESIGNATION	DESCRIPTION	FLOOR AREA	CUBIC AREA	FLOOR	WALL	CEILING	BASE
100	OFFICE	121	1051	CARPET	3/4" VINYL COVERED GYPSUM TYPE X	2'X4' LAY IN	4" RUBBER BASE
101	BATHROOM	42	364	TILE	FRP OVER 5/8" GYPSUM TYPE X	2'X4' LAY IN	4" RUBBER BASE
102	WORK AREAS AND SINK AREA	449	3891	TILE	3/4" VINYL COVERED GYPSUM TYPE X	2'X4' LAY IN	4" RUBBER BASE
103	OFFICE	121	1051	CARPET	3/4" VINYL COVERED GYPSUM TYPE X	2'X4' LAY IN	4" RUBBER BASE
104	TELECOM	5	43	TILE	3/4" VINYL COVERED GYPSUM TYPE X	2'X4' LAY IN	4" RUBBER BASE

WINDOW SCHEDULE			
DESIGNATION	DESCRIPTION	RD	QTY
W1	2044 ALUMINUM BRONZE FRAME, DOUBLE INSULATED LOW E GLASS W/ ALUMINUM MINI BLINDS	24 1/2' X 52 1/2'	5

DOOR SCHEDULE					
DESIGNATION	SIZE	DOOR MATERIAL	FRAME	RD	QTY
D1	306BL	STEEL W/ PENCIL VISION	STEEL	40 1/2' X 82 1/2'	1
D2	306BL	NOHAWK SOLID CORE W/ VISION GLASS	REDIFRAME	37' X 81"	1
D3	306BR	NOHAWK SOLID CORE W/ VISION GLASS	REDIFRAME	37' X 81"	1
D4	306BL	NOHAWK SOLID CORE	REDIFRAME	37' X 81"	1
D5	206BR	NOHAWK SOLID CORE	REDIFRAME	25' X 81"	1

COMCHECK AREA
 (1)SIDEWALL = 60' X 9'-1 1/8" = 545.6SF + PEAK AREA OF 18SF = 536.6 SF
 (1)ENDWALL = 13'-9" X 9'-1 1/8" = 125SF
 SIDEWALL X 2= 1073SF + ENDWALL X 2 = 250 FOR A TOTAL OF 1323SF

Texas Industrial Building Code Council
 APR 08 2008
 Approved: PFS Corp. IHD/RA 7

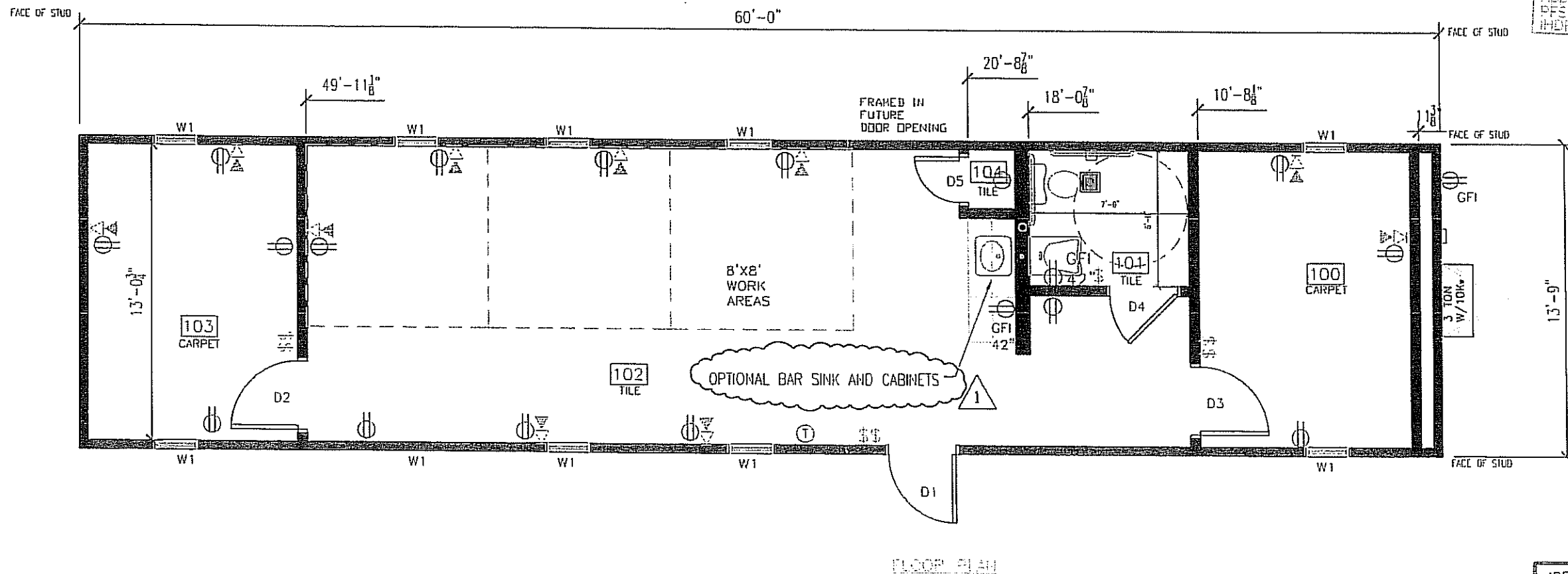

LTR	REVISION	BY	DATE	DRAWN BY: REW	PROJECT: NORTEX 1460 VALUE	TITLE: FLOOR PLAN	DWG#: 14X60VALUESTK	SHEET: A-101	JOE STEEDE, P.E. 13999 GOLDMARK, SUITE 374 DALLAS, TX 75250 PHONE 972-238-1611 NORTEX MODULAR SPACE 555 JUBILEE LANE LEWISVILLE, TX 75056 PHONE: 972-492-4040 FAX: 972-492-2704
				DATE: 03/28/08	SCALE: 1/4" = 1'-0"				